

NP12-160(12V160AH)

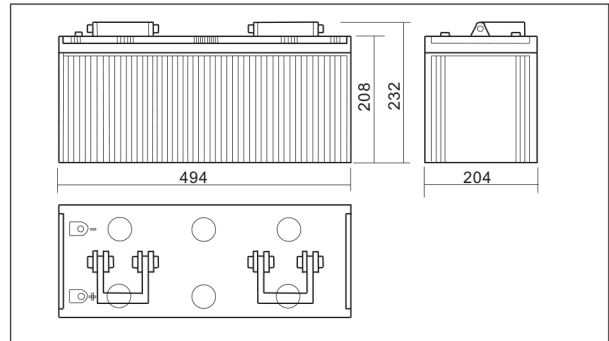

● **Outer dimensions (mm)**



● **Specifications**

| | | |
|-------------------------------|--------------|--------------------|
| Nominal Voltage | | 12V |
| Rated capacity (10 hour rate) | | 160 Ah |
| Dimensions | Total Height | 232mm (9.13inches) |
| | Height | 208mm (8.19inches) |
| | Length | 494mm (19.4inches) |
| | Width | 204mm (8.03inches) |
| Weight Approx | | 49.0Kg (107.8lbs) |

● **Terminal Type (mm)**

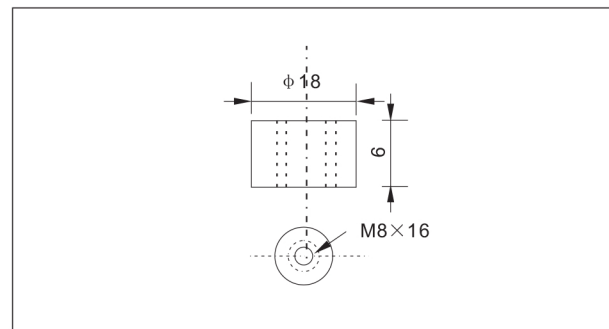

● **Characteristics**

| | | |
|---|--|---|
| Capacity 25°C(77°F) | 10 hour rate(16.0 A) | 160AH |
| | 5 hour rate(25.6A) 1 hour rate(88A) | 128AH 88AH |
| | 1.5 hour discharge to 10.5V | 59 A |
| Internal Resistance | Full charged Battery at 25°C(77°F) | 3.7mΩ |
| Capacity affected by Temperature (10hour rate) | 40°C(104°F) | 102% |
| | 25°C(77°F) | 100% |
| | 0°C(32°F) | 85% |
| | -15°C(5°F) | 65% |
| Self-Discharge at 25°C(77°F) | Capacity after 3 month storage | 91% |
| | Capacity after 6 month storage | 82% |
| | Capacity after 12 month storage | 64% |
| Terminal | | T18 |
| Charge (constant Voltage) | Cycle | Initial Charging Current less than 64 A Voltage 14.10-14.40V |
| | Float | Voltage 13.50-13.80V |

● **Discharge Curves 25°C(77°F)**

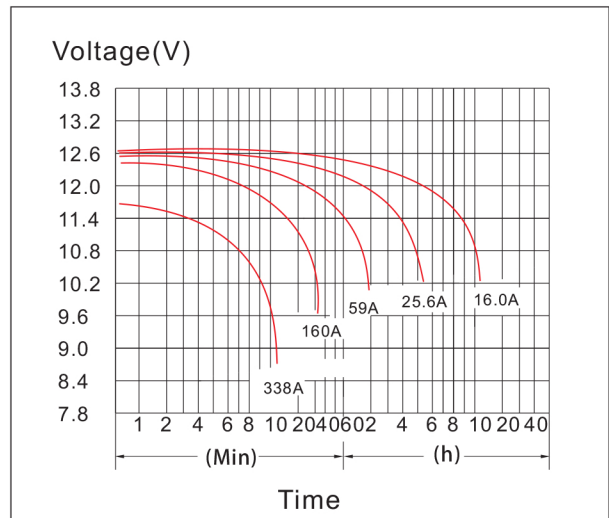

| Time | | 5min | 10min | 15min | 30min | 1h | 2h | 3h | 4h | 5h | 8h | 10h | 20h |
|--------|---|------|-------|-------|-------|------|------|------|------|------|-------|-------|-------|
| 9.60V | A | 512 | 338 | 272 | 182.4 | 96.0 | 56.0 | 41.1 | 32.0 | 26.4 | 18.72 | 16.80 | 9.07 |
| | W | 5289 | 3606 | 2918 | 1961 | 1037 | 615 | 458 | 360 | 300 | 215 | 194 | 105.5 |
| 10.20V | A | 496 | 305 | 256 | 174.4 | 90.2 | 53.4 | 40.0 | 31.2 | 25.9 | 18.24 | 16.48 | 8.80 |
| | W | 5301 | 3402 | 2868 | 1958 | 1021 | 616 | 463 | 363 | 302 | 213 | 194 | 103.2 |
| 10.50V | A | 480 | 272 | 224 | 163.2 | 87.4 | 52.2 | 39.0 | 30.7 | 25.6 | 18.08 | 16.16 | 8.80 |
| | W | 5243 | 3100 | 2558 | 1878 | 1012 | 605 | 455 | 359 | 300 | 213 | 191 | 104.0 |
| 10.80V | A | 463 | 257 | 208 | 150.4 | 84.5 | 50.9 | 38.1 | 30.2 | 25.0 | 17.60 | 16.00 | 8.64 |
| | W | 5192 | 2961 | 2400 | 1743 | 983 | 596 | 449 | 357 | 295 | 209 | 190 | 102.9 |
| 11.10V | A | 447 | 241 | 192 | 134.4 | 81.6 | 49.6 | 36.8 | 29.4 | 24.3 | 17.12 | 15.20 | 8.16 |
| | W | 5071 | 2787 | 2239 | 1572 | 960 | 586 | 437 | 351 | 290 | 205 | 183.5 | 98.9 |