

NP12-165(12V165AH)

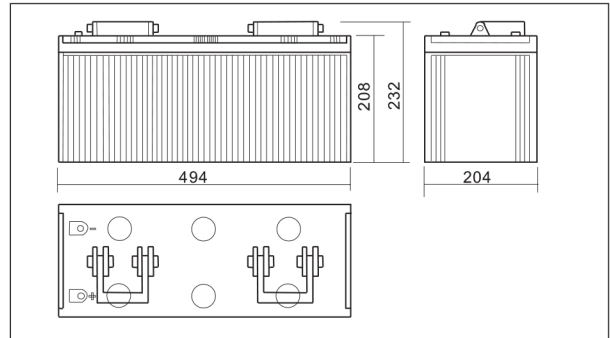

Outer dimensions (mm)



Specifications

Nominal Voltage		12V
Rated capacity (10 hour rate)		165 Ah
Dimensions	Total Height	232mm (9.13inches)
	Height	208mm (8.19inches)
	Length	494mm (19.4inches)
	Width	204mm (8.03inches)
Weight Approx		49.0Kg (107.8lbs)

Terminal Type (mm)

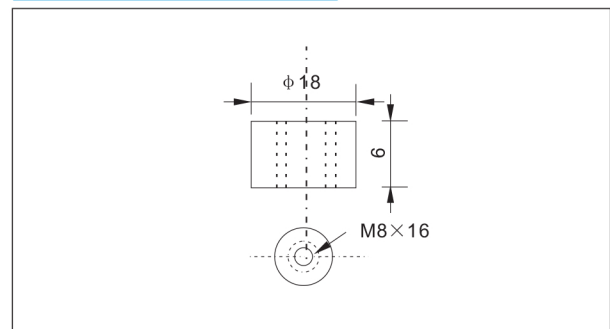

Characteristics

Capacity 25°C(77°F)	10 hour rate(16.5 A)	165AH
	5 hour rate(26.4A)	132AH
	1 hour rate(99A)	99AH
	1.5 hour discharge to 10.5V	66 A
Internal Resistance	Full charged Battery at 25°C(77°F)	3.7mΩ
Capacity affected by Temperature (10hour rate)	40°C(104°F)	102%
	25°C(77°F)	100%
	0°C(32°F)	85%
	-15°C(5°F)	65%
Self-Discharge at 25°C(77°F)	Capacity after 3 month storage	91%
	Capacity after 6 month storage	82%
	Capacity after 12 month storage	64%
Terminal	T11	
Charge (constant Voltage)	Cycle	Initial Charging Current less than 66 A Voltage 14.10-14.40V
	Float	Voltage 13.50-13.80V

Discharge Curves 25°C(77°F)

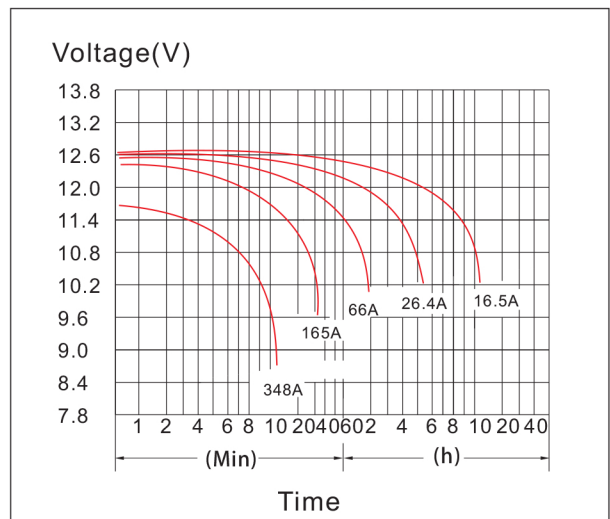

Constant Current(Amp) and Constant Power(Watt) Discharge Table at 25°C(77°F)

Time		5min	10min	15min	30min	1h	2h	3h	4h	5h	8h	10h	20h
9.60V	A	528	348	281	188.1	99.0	57.8	42.4	33.0	27.2	19.31	17.33	9.36
	W	5454	3718	3009	2022	1069	634	472	371	310	221	200	108.8
10.20V	A	512	314	264	179.9	93.1	55.1	41.3	32.2	26.7	18.81	17.00	9.08
	W	5466	3508	2958	2019	1053	635	478	374	312	220	200	106.4
10.50V	A	495	281	231	168.3	90.1	53.8	40.3	31.7	26.4	18.65	16.67	9.08
	W	5407	3197	2638	1937	1043	624	469	371	310	219	197	107.3
10.80V	A	477	265	215	155.1	87.1	52.5	39.3	31.2	25.7	18.15	16.50	8.91
	W	5354	3054	2475	1797	1014	615	463	368	304	215	196	106.1
11.10V	A	461	248	198	138.6	84.2	51.2	38.0	30.4	25.1	17.66	15.68	8.42
	W	5230	2874	2309	1622	990	605	451	362	299	211	189.2	102.0